

SALES PLAT

Piperton Preserve

PHASE 2

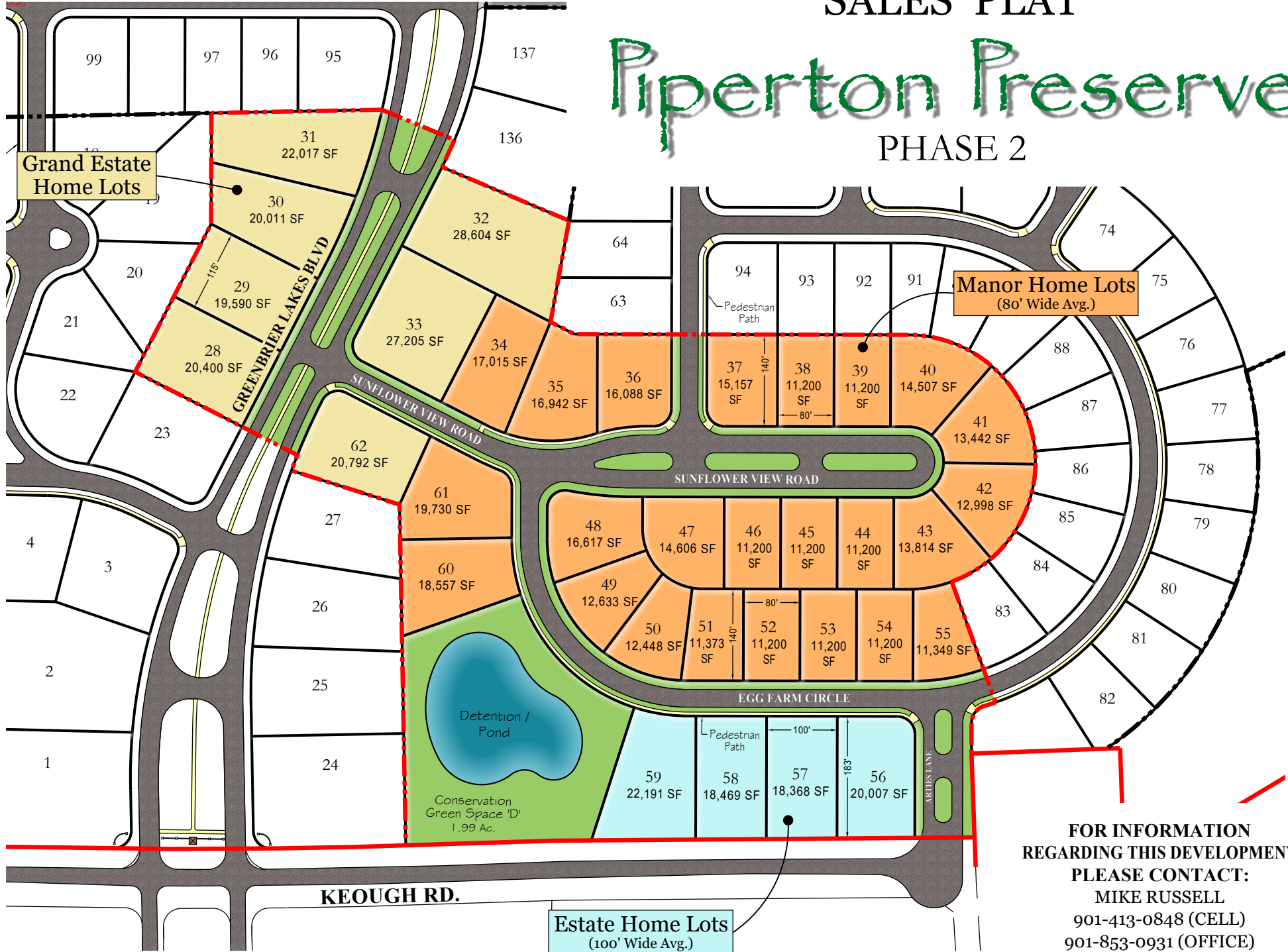

**FOR INFORMATION
REGARDING THIS DEVELOPMENT
PLEASE CONTACT:
MIKE RUSSELL
901-413-0848 (CELL)
901-853-0931 (OFFICE)**

NOTE: Exact Lot sizes and dimensions subject to the Final Plat